

DEMOLISH & REMOVE FROM THE SITE, AS PER THE SPECIFICATION, THE COUNCIL REQUIREMENTS & AS. 2601 ALL THE EXISTING BUILDINGS, CARPORT, FENCES, DRIVEWAY, PATHS AND THE LIKE AS SHOWN HATCHED AND/OR AS REQUIRED TO ACHIEVE THE PROPOSED WORK. DISCONNECT, CAP OFF & SEAL ALL REDUNDANT SERVICES PRIOR TO THE COMMENCEMENT OF DEMOLITION

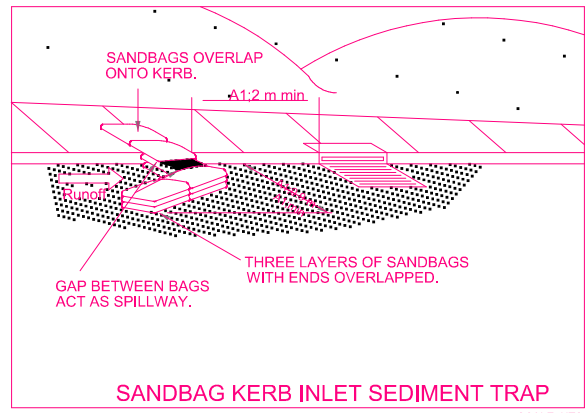
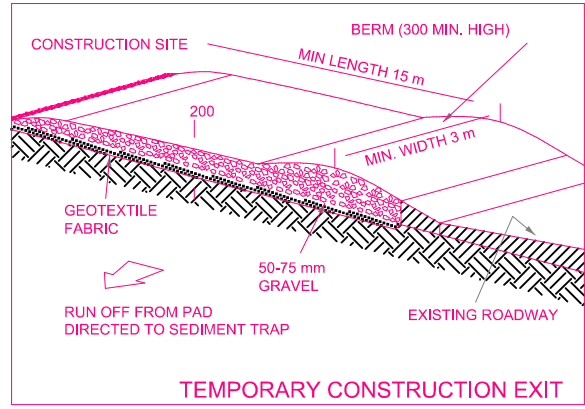
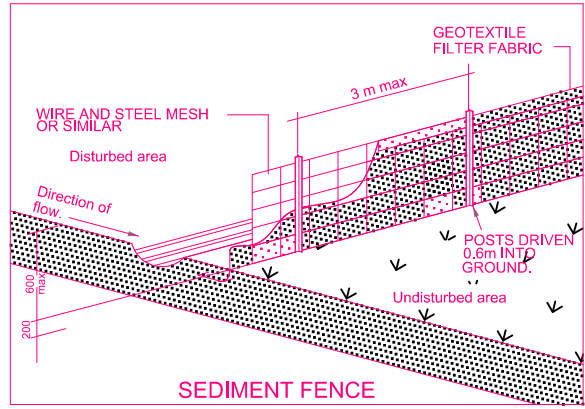

WARNING

SOIL & WATER:
 * INSTALL SEDIMENT CONTROL FENCES ALONG THE LOW SIDE OF THE SITE BEFORE WORK BEGINS.
 * STABILISE A SINGLE ENTRY/EXIT POINT USING LARGE AGGREGATE.
 * MINIMISE DISTURBANCE OF VEGETATION DURING EXCAVATION.
 * PLACE SOIL STOCKPILES BEHIND SEDIMENT FENCING.
 * KEEP THE ROAD AND FOOTPATH CLEAN BY SWEEPING REGULARLY.

WASTE:
 * CONSTRUCT TWO (2) WASTE BAYS TO ASSIST SORTING AND RECYCLING OF WASTE.
 * ALL WASTE MUST BE CONTAINED IN WASTE BAYS.
 * REUSE AND RECYCLING OF WASTE SHOULD BE MAXIMISED.

EROSION CONTROL:
 All disturbed areas shall be progressively stabilised and/or revegetated so that no areas remain exposed to potential erosion damage for a period of greater than 14 days.

LEGEND

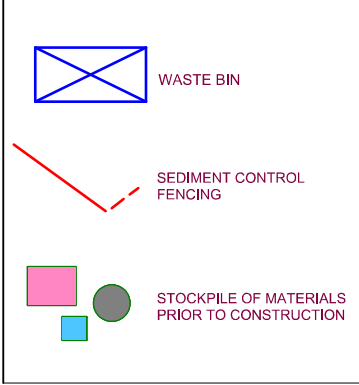

Client :
Mr & Mrs Meylakh

Project Title :
**Proposed Carport at:
 Lot B, 20 Wollli Avenue, Earlwood**

E		
D		
C		
B		
A	--/05/24	DA SUBMISSION
No.	Date	Revision

Not FOR CONSTRUCTION

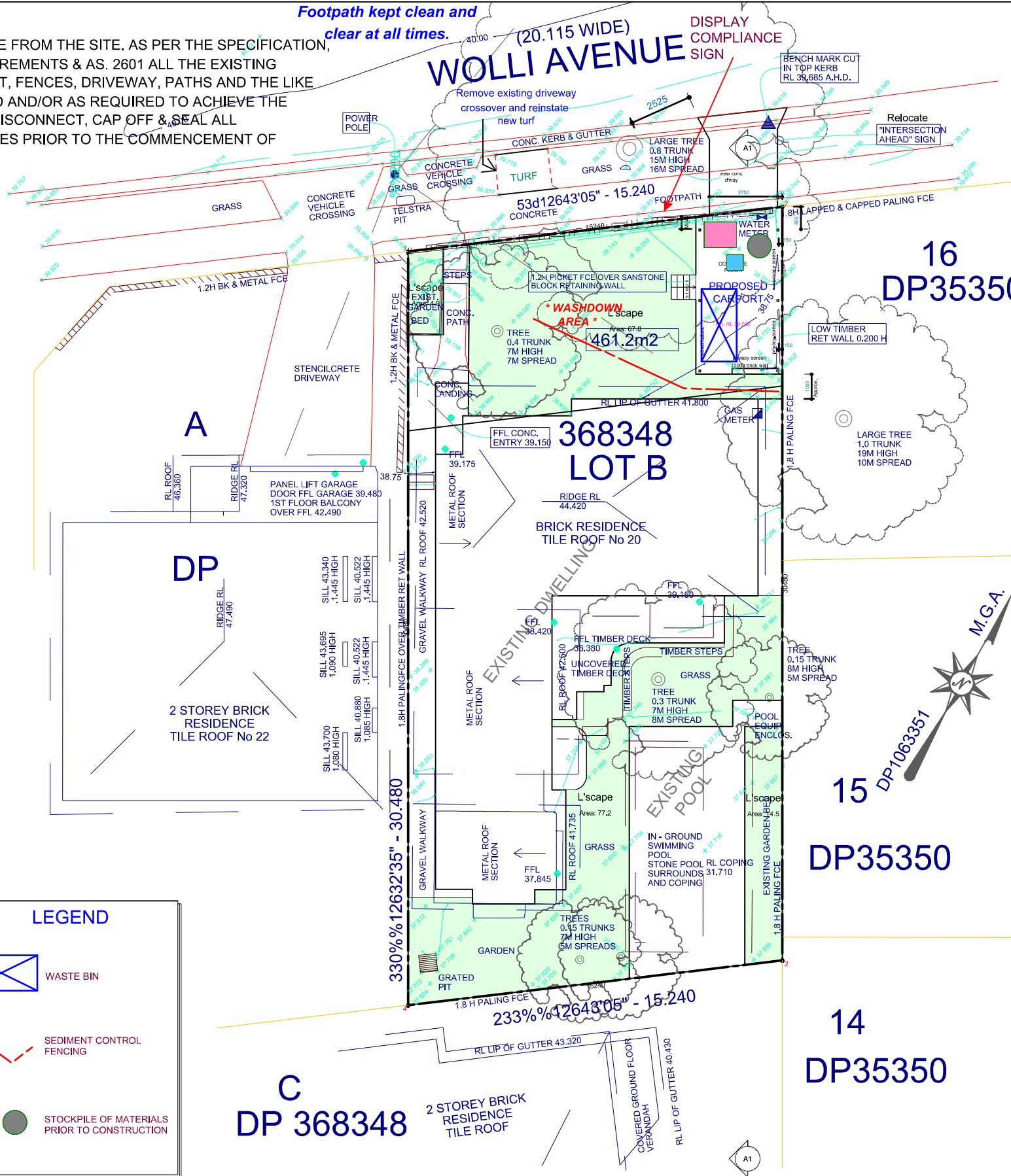

WASTE MANAGEMENT NOTES

- LOCATION OF STOCKPILE MATERIAL & WASTE. ie.
- BRICKS, TILES & SIMILAR MATERIALS.
- TIMBER OFFCUTS AND RECYCLABLE MATERIALS.
- WASTE FOR LANDFILL DISPOSAL OF DEMOLITION MATERIALS TO WASTE DISPOSAL CENTRE
- SELECTED STRUCTURAL TIMBER, BRICKS & TERRA-COTTA OR COLBOND ROOF CONSTRUCTION OF PROPOSED RESIDENCE

NOTES
 1. SOIL AND EROSION CONTROL MEASURES:
 i) NO PARKING OR STOCKPILING OF MATERIAL IS PERMITTED ON FOOTPATH.
 ii) ACCESS IS TO BE GAINED VIA TEMPORARY ENTRY
 iii) SILT STOP FENCING TO BE PLACED ALONG THE NORTH, SOUTH AND WEST BOUNDARIES. PROVIDE SILT STOP FENCING ON THE EASTERN SIDE WHERE SHOWN ON PLAN.

2. MAINTENANCE PROCEDURES DURING CONSTRUCTION:
 i) ALL EROSION CONTROL MEASURES ARE TO BE MAINTAINED AT ALL TIMES SO THAT THOSE MEASURES ARE FULLY FUNCTIONAL/OPERATIONAL DURING THE CURRENCY OF WORKS. ALL SUCH CONTROLS MUST ALSO BE FULLY FUNCTIONAL/ OPERATIONAL SHOULD WORK OPERATIONS CEASE TEMPORARILY. (eg WEEKENDS, ROSTERED DAYS OFF, etc.)
 ii) ALL FILTER BARRIERS ARE TO BE REGULARLY INSPECTED, PARTICULARLY FOLLOWING RUNOFF EVENTS, SO THAT DISLODGED OR BROKEN BALES/BAGS CAN BE IMMEDIATELY REPLACED. SEDIMENT ACCUMULATION BEHIND STRAWBALE SANDBAGS SHALL BE REMOVED.
 iii) RESPREAD MATERIAL GAINED DURING MAINTENANCE OPERATION OR ALTERNATIVELY PLACE ON STOCKPILES.

NOTES:
 1. MINIMISE DISTURBED AREAS.
 2. ALL STOCKPILES TO BE CLEAR FROM DRAINS, GUTTERS AND FOOTPATH.
 3. ROADS AND FOOTPATHS TO BE SWEEPED DAILY.
 4. ALL TRUCK LOADS ARE TO BE COVERED WHEN ENTERING AND EXITING THE SITE SO AS TO AVOID SPILLAGE.

ANY DAMAGE TO EXISTING &/OR ADJOINING PROPERTY &/OR SERVICES IS TO BE MADE GOOD WITH MINIMAL IF ANY INCONVENIENCE TO ALL PROPRIETORS. IF ANY DAMAGE IS DUE TO NEGLIGENCE, IT IS TO BE RECTIFIED AT THE COST OF THE NEGLIGENT PARTY WHICH CAUSED THAT DAMAGE.

NOTES:
 VEHICLES CARRYING LOOSE BUILDING MATERIALS TO BE COVERED IN COMPLIANCE WITH ROAD TRAFFIC REGULATIONS. SAFE ACCESS FOR HEAVY EQUIPMENT PLANT AND MATERIALS DELIVERY.
 SEDIMENT CONTROLS TO BE PLACED ACROSS DRIVEWAY

NOTES:
 PROVIDE 1800mm HIGH SAFETY & SECURITY FENCE FOR THE DURATION OF THE DEMOLITION & CONSTRUCTION WORKS. SILT FENCE, GEOTEXTILE FABRIC OR THE EQUIVALENT TO ALL BOUNDARIES

dbb design - basix - build

M: 0417 45 888 6
 E: design@d-b-b.com
 W: d-b-b.com

bdca ACCREDITED BUILDING DESIGNER

experienced & practising designer & builder Since 1997

Note:
 -Do not scale off drawings
 -All works to be set out by a registered survey
 -Builder or contractor to verify all dimensions & levels as well notify the designer of any discrepancies prior to commencing any work
 -Refer to Engineers drawings for structural details
 © Copyright of design and information shown here is retained and authority is required for any reproduction.
 -Not for Construction unless noted otherwise in the issue and revision block

SOIL EROSION & WASTE MANAGEMENT PLAN

Scale: 1:200	Drawn By: dbb	Drawing No. 09
Date: 20/02/24	Issue: DA-A	